

May 15, 1995

Introduced By:

BRIAN DERDOWSKI

samm94-1:kn

Proposed No.:

95 - 376

ORDINANCE NO. **11807**

AN ORDINANCE relating to the annexation of an area known as 94-1 to the Sammamish Plateau Water & Sewer District for the provision of water service and an extension of sewer service.

STATEMENT OF FACT:

1. Intention of the proposed annexation of territory known as Annexation 94-1 to the Sammamish Plateau Water and Sewer District was filed with the county council effective May 9, 1995.

2. Sammamish Plateau Water and Sewer District has found the petition for annexation to be sufficient and has, by Resolution No. 1785, concurred with the proposed annexation.

3. Sammamish Plateau Water and Sewer District filed a Determination of Nonsignificance dated July 7, 1994, on the proposed annexation.

4. The county council held a public hearing on the day of June 5, 19 95 and has considered the criteria set forth in R.C.W. 56.03.060 and R.C.W. 57.02.040.

SECTION 1. The annexation of territory known as Annexation 94-1 by the Sammamish Plateau Water and Sewer District, and described in Attachment A, is approved. This proposed annexation is consistent with R.C.W. 56.03.060 and R.C.W. 57.02.040.

SECTION 2. The Sammamish Plateau Water and Sewer District is the appropriate entity to provide water and sewer service to the area proposed to be annexed.

1  
2  
3  
4  
5  
6  
7  
8  
9  
10  
11  
12  
13  
14  
15  
16  
17  
18  
19  
20  
21

SECTION 3. Completion of this annexation does not constitute county approval or disapproval of any other permits, certifications, or actions necessary to provide service to this annexation area.

INTRODUCED AND READ for the first time this 22nd day of May, 1995.

PASSED by a vote of 13 to 0 this 5<sup>th</sup> day of June, 1995.

KING COUNTY COUNCIL  
KING COUNTY, WASHINGTON

Kent Pullen  
Chair

ATTEST:

Gerald A. Peterson  
Clerk of the Council

APPROVED this 15<sup>th</sup> day of June, 1995.

Doug Locke  
King County Executive

Attachments:

Map

Legal Description

EXHIBIT "B"

11807

RECEIVED

95 MAY -9 PM 2:06

CLERK KING COUNTY COUNCIL

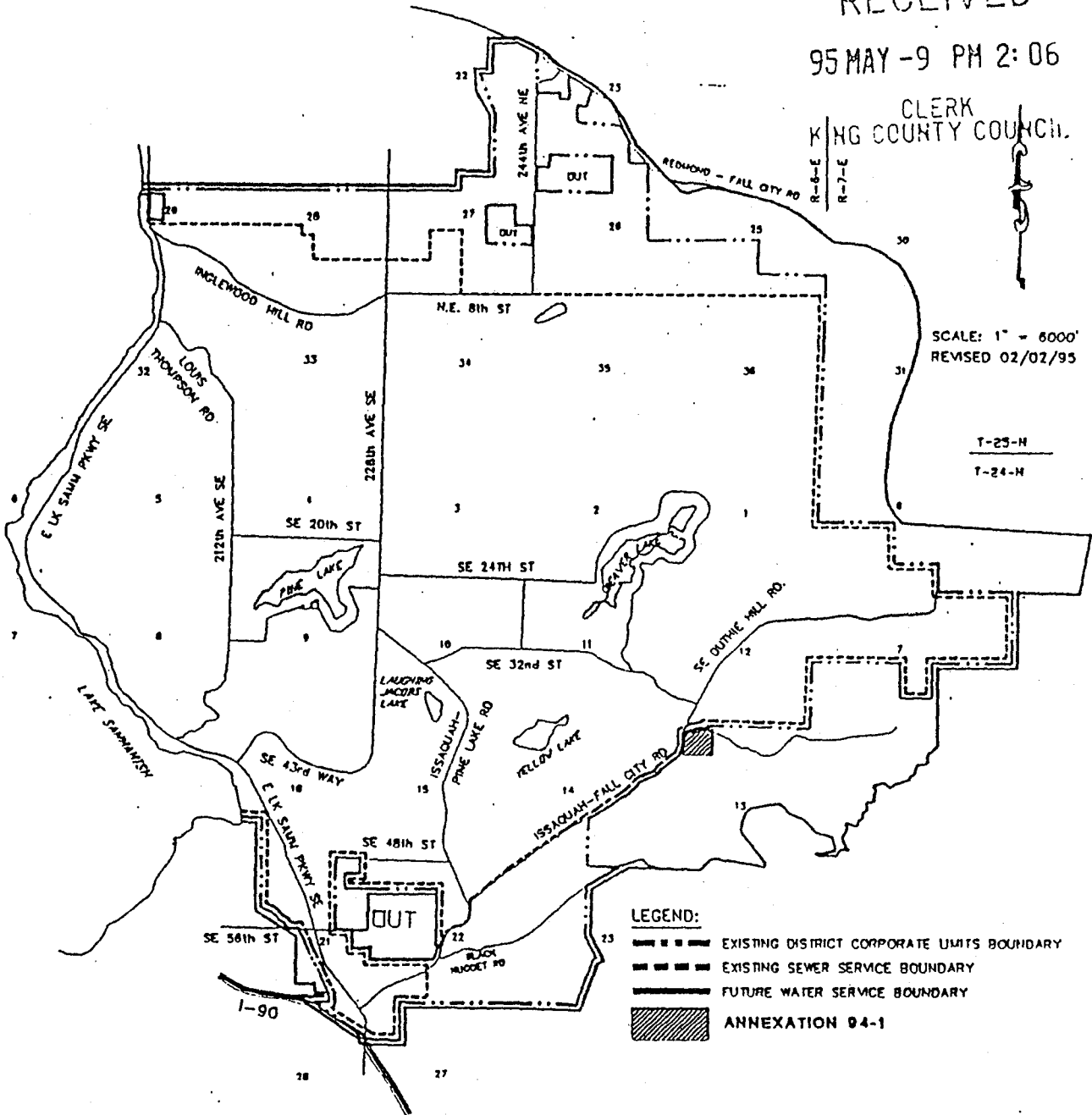

SCALE: 1" = 6000'  
REVISED 02/02/95

T-25-N  
T-24-N

LEGEND:

- EXISTING DISTRICT CORPORATE LIMITS BOUNDARY
- - - EXISTING SEWER SERVICE BOUNDARY
- FUTURE WATER SERVICE BOUNDARY
- ▨ ANNEXATION 94-1

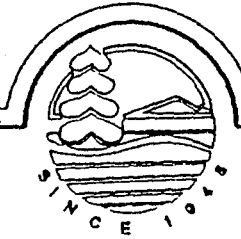

1510 228TH S.E. ISSAQUAH, WA. 98027  
(206) 392-4931 / 883-9333  
FAX 391-5389

11807

SAMMAMISH PLATEAU WATER AND SEWER DISTRICT  
ANNEXATION 94-1  
(aka ISSAQUAH SCHOOL SITE E-11)

LEGAL DESCRIPTION

19 Acres, more or less, including - That portion of the north half of the northwest quarter of Section 13, T 24 N, R 6 E, Willamette Meridian, in King County, Washington, described as follows:

Beginning at the southwest corner of the northeast quarter of the northwest quarter of said Section 13; thence South  $88^{\circ}22'11''$  East along the south line thereof 10.00 feet; thence North  $01^{\circ}37'49''$  East 49.25 feet; thence North  $43^{\circ}24'13''$  East 592.10 feet; thence North  $32^{\circ}11'28''$  West 594.95 feet; thence North  $01^{\circ}24'15''$  East 50.00 feet to the southerly margin of Issaquah-Fall City Road; thence continuing North  $01^{\circ}24'15''$  30 feet to the centerline of SE Issaquah-Fall City Road; thence following the centerline of Issaquah-Fall City Road westerly along said centerline to the centerline of the intersection of S.E. Duthie Hill Road and Issaquah-Fall City Road; thence following the centerline of Issaquah-Fall City Road south to the point where it intersects the south line of the northwest quarter of the northwest quarter of said section 13; thence South  $88^{\circ}22'11''$  East along said south line to the easterly margin of SE Issaquah-Fall City Road; then continuing South  $88^{\circ}22'11''$  East along said south line 897.03 feet to the Point Of Beginning.

RECEIVED  
95 MAY 16 AM 10:30  
CLERK  
KING COUNTY COUNCIL